

PRODUCT SUBMITTAL

BlockNet[®]

DESCRIPTION

BLOCKNET[®] reliably protects single wythe concrete block walls from damage caused by water infiltration, providing an open path for water to migrate to the exterior of the building. The stainless steel flashing strips with mesh material, integrated weep tabs, and vertical mesh elements form a continuous drainage system around the entire perimeter of a concrete block building. Install BlockNet[®] as close to the foundation as possible but not above the interior floor. BlockNet[®] can be used over wall openings, bond beams, and structural steel members if the ends are properly dammed. BlockNet[®] is suitable for all wall thickness.

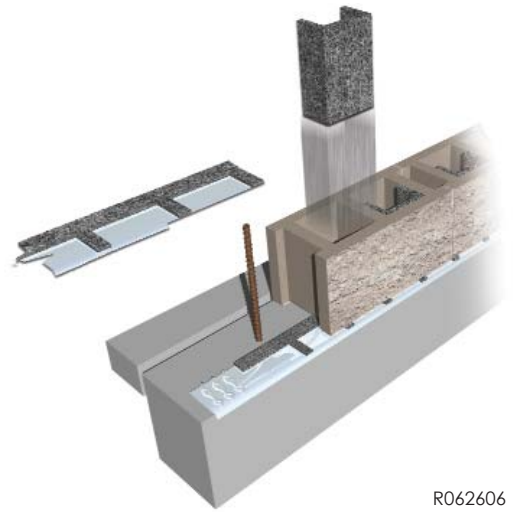

R062606

SHORT FORM SPEC

Stainless steel drainage strip with integrated drip edge, adhered horizontal mesh, rear water dam, and 90 percent open weave polyester vertical mesh elements. Install per manufacturer's instructions.

Product: Subject to compliance with requirements, provide "BlockNet[®]" by Mortar Net USA, Ltd.

MANUFACTURER

Mortar Net USA, Ltd.
541 South Lake Street, Gary, IN 46403
Telephone: (800) 664-6638
Fax: (219) 939-3877
Email: info@mortarnet.com
Website: www.MortarNet.com

Specifier Note: BlockNet[®] system is composed of specially shaped 3-3/8" deep 28-gauge stainless steel drainage strips with integrated drip edge, 1/8" thick adhered horizontal mesh element, and rear water dam. The second part of this two-part system is the separate vertical mesh elements that wick moisture past mortar droppings and on to the horizontal mesh element. One 1/4" thick, 7" x 7" vertical element is placed in each individual block core against the face of the core, forming a "U" shape and comes in contact with the horizontal mesh on the stainless steel drainage strip. The horizontal and vertical mesh is a 90% open weave polyester that will not oxidize, rot, promote mold or fungus growth, or react with other common building materials.

SUBSTITUTIONS

No substitutions permitted.

BN120 - shipped in boxes of 20, 6 foot long stainless steel drainage strips, plus 150 7" x 7" vertical mesh elements. Each box contains enough material for approximately 110 lineal feet of wall.

DATE: _____

PROJECT: _____

FIRM: _____ PHONE: _____

APPROVAL: _____ DATE: _____

GENERAL CONTRACTOR: _____

BID DATE: _____

COMMENTS: _____
